

HP SERIES-Grey PGI 2-3326

EAN 8422202233260



Technical Data

Housing Type	Swivel
Fitting Type	Stem
Braking System	Wheel Brake
Material	Rubber
Bearing	Plain
Diameter (mm)	100
Width of tyre (mm)	25
Width x height of stem	10x20
Offset (mm)	90
Overall height (mm)	132
Load	40
Unit Weight of the wheel (kg)	0.3
Volume (cm ³)	986

CAD

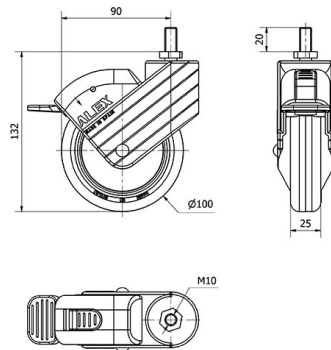

To visualize the image with higher resolution and more technical details, please access to the CAD section

Brackets

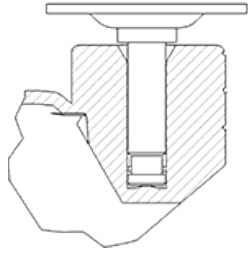

Made of reinforced polyamide Casing with flushed recess for the rounded ergonomic brake Manufactured to European Standard EN 12528

Similar products



2-3323



2-3324



2-3325

Wheel



Grey rubber tyre on polypropylene centre
Temperature range: -20° ÷ +60°

